



# 6-in-1 Combination Bucket

For

**Skid Steer Loaders**

**Operator's Manual**  
**Maintenance**  
**Parts Information**



**Read this Manual Before Use**

**TABLE OF CONTENTS**

---

SAFETY	3-4
SERIAL NUMBER/DECAL LOCATION	5-6
USER'S MOUNTING INSTRUCTIONS	7-8
OPERATING INSTRUCTIONS	9-10
ROUTINE MAINTENANCE	11
BOLT TORQUE INFORMATION	12
PARTS INFORMATION	13-17
GENERAL SPECIFICATIONS	18
WARRANTY	19

**REFERENCE INFORMATION**

**Write the serial number for your attachment in the spaces below. Always refer to this serial number when calling for service or parts.**

Serial Number.....\_\_\_\_\_

**YOUR ATTACHMENT DEALER**

\_\_\_\_\_  
**ADDRESS:**

\_\_\_\_\_  
**PHONE:**

\_\_\_\_\_  
**CONTACT:**

\_\_\_\_\_

**NOTE:** *Erskine Attachments LLC reserves the right to make improvements in design or changes in specifications at any time without notice and without incurring any obligations to install them on units previously sold.*

# SAFETY

---

**DO NOT use or perform maintenance on this machine until this manual has been read and understood. In addition, read the Operation and Maintenance Manual(s) pertaining to the attachment and the attachment carrier (“Loader”).**

The user is responsible for inspecting the machine daily, and for having parts repaired or replaced when continued use of the machine would cause damage, excessive wear to other parts or make the machine unsafe for continued operation.

If an operating procedure, tool device, maintenance or work method not specifically recommended is used, you must satisfy yourself that it is safe for you and others. You must also ensure that the attachment will not be damaged or made unsafe by the procedures you choose.

Erskine Attachments LLC cannot anticipate every possible circumstance that might involve potential hazard. The safety messages found in this manual and on the machine are therefore not all inclusive.

Throughout this manual, reference may be made to the left hand (LH) and right hand (RH) side. These terms are used as viewed from the operator’s seat facing front.

The signal words **CAUTION**, **WARNING**, or **DANGER** are used to indicate hazards.

**⚠ CAUTION** Indicates a potentially hazardous situation which, if not avoided, may result in minor or moderate injury.

**⚠ WARNING** Indicates a potentially hazardous situation which, if not avoided, could result in death or serious injury.

**⚠ DANGER** Indicates a potentially hazardous situation which, if not avoided, will result in death or serious injury.

The word **IMPORTANT** is used in the text when immediate damage will occur due to improper technique or operation.

The word **NOTE** is used to convey information that is out of context with the manual text; special information such as specifications, techniques, reference information, and other information of a supplementary nature.

## Call Before You Dig

### 1-888-258-0808



## Improper operation can cause serious injury or death.

### Pre-operation

- This machine is designed to backfill, grade, and level dirt, sand, and other materials. It is also designed to grapple and transport large objects. **NEVER** use this machine for any other purpose.
- Read the operator's manual for the "Skid Steer Loader." **NEVER** allow untrained people to operate.
- Operating instructions must be given to everyone before operating this attachment and at least once a year thereafter in accordance with OSHA regulations.
- **NEVER** exceed the maximum recommended input power or speed specifications for the attachment. Over-powering or over-speeding the attachment may cause personal injury and/or machine damage.
- Keep all shields, guards, and covers in place.
- Do not modify equipment or add attachments that are not approved by Erskine Attachments LLC.
- Use adequate safety warning lights and devices as required by local regulations. Obey all local laws and regulations regarding machine operation on public property. Always call before you dig (1-888-258-0808). When you call, you will be directed to a location in your state/city for information about buried lines (electric, telephone, cable TV, water, sewer, gas, etc.).

### Operation

- Always wear eye protection that meets ANSI z87.1 standard or use with a loader enclosure that provides similar protection.
- Hydraulic connections may be hot after use. Use gloves if connecting or disconnecting after use.
- Check and be sure all operating controls are in neutral before starting the engine.
- Keep people away from loader and attachment when in use. This attachment lifts objects and has moving parts. **NEVER** lift load directly over people – load could fall.

### Operation (continued)

- To avoid electric shock or electrocution, **NEVER** operate the attachment near overhead power lines.
- **NEVER** operate near embankments or terrain that is so steep that rollover could occur.
- Always stay in the operator position when using the attachment.
- Before leaving the operators position, disengage hydraulic drive, lower the attachment to rest flat on the ground, stop engine, set park brake, and wait for all motion to stop.
- **NEVER** place hands near moving parts or clear debris while engine is running.
- **NEVER** lift people.

### Avoid High Pressure Fluids Hazard



- Escaping fluid under pressure can penetrate the skin causing serious injury.
- Avoid the hazard by relieving the pressure before disconnecting hydraulic lines.
- Use a piece of paper or cardboard, NOT BODY PARTS, to check for suspected leaks. Wear protective gloves and safety glasses or goggles when servicing or performing maintenance on hydraulic systems.
- If an accident occurs, see a doctor immediately. Any fluid injected into the skin must be surgically removed within a few hours or gangrene may result.

### Maintenance

- **NEVER** make adjustments, lubricate, clean, or perform any service on the machine while it is in operation.
- Make sure the attachment is serviced on a daily basis. Improper maintenance can cause serious injury or death in addition to damage to the attachment and/or your equipment.

# SERIAL NUMBER AND SAFETY DECAL LOCATIONS

## Serial Number Location:

It is important to refer to the serial number of the attachment when making repairs or ordering parts. Early or later models (identification made by serial number) may use different parts, or it may be necessary to use different procedures in doing a specific operation.

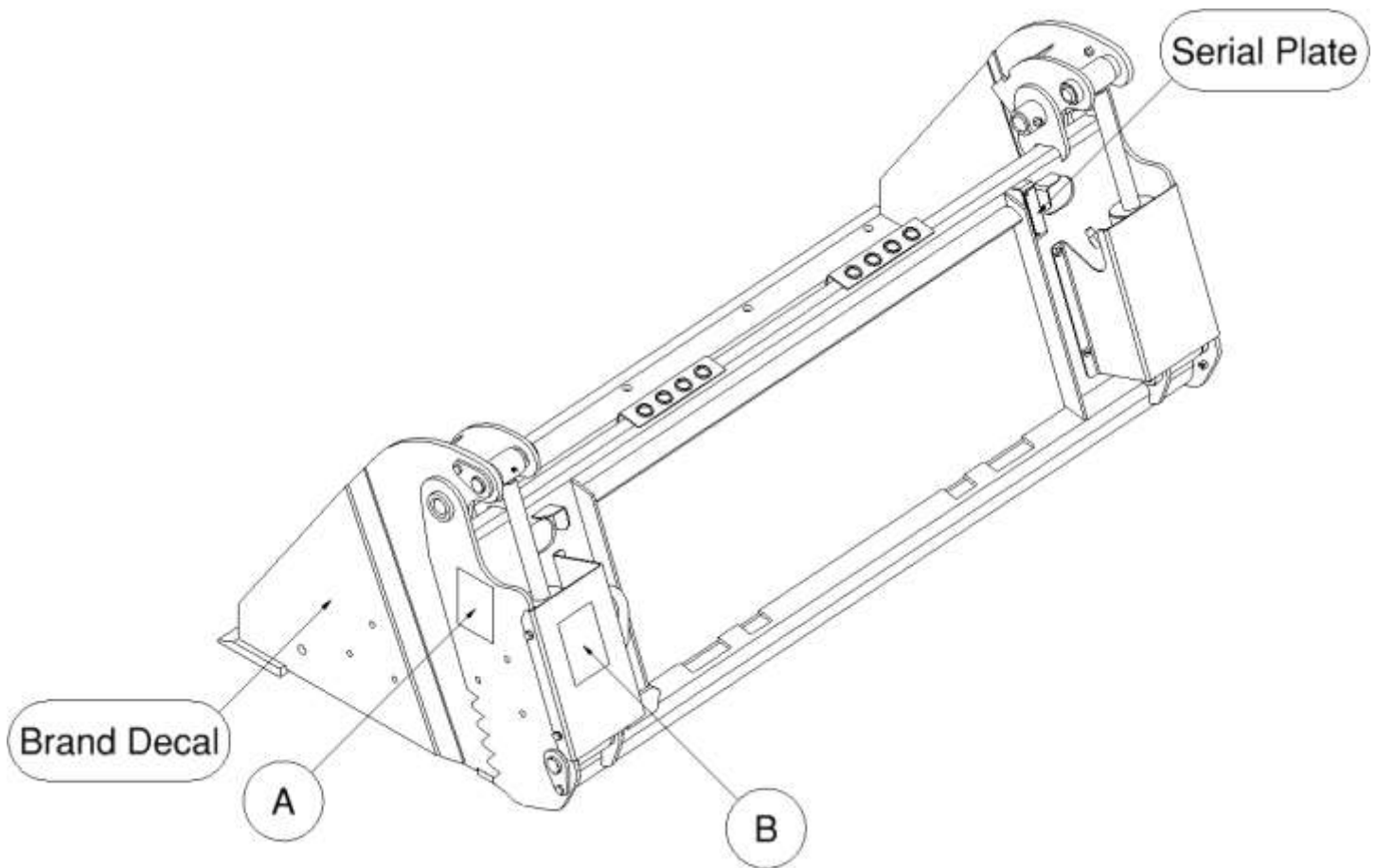

## SERIAL NUMBER AND SAFETY DECAL LOCATIONS



**Part number: 203234**

**Location:** On each endplate

**Quantity: 2**

### **Small Brand Decal**

**Location:** On each endplate

**Quantity: 2**



**Part number: 200001**

**Location:** On back of left cylinder cover

**Quantity: 1**

### **Safety Decals Locations:**

The locations of the safety decals are shown. If these decals are missing, damaged, or painted over they must be replaced. Call Erskine Attachments LLC (218-435-4045) for replacement decals.

## USER'S MOUNTING INSTRUCTIONS

After the initial set-up assembly is completed use the following procedure to mount the attachment to the loader for user operation.

**⚠ WARNING** Coupler wedges or pins must extend through holes in attachment. Levers must be fully down and locked. Failure to secure wedges or pins can allow the attachment to come off and cause injury or death.



1. Use the step, safety treads, and grab handles to get on and off the loader and attachment.

2. Sitting in the operator's seat, lower seat bar (if so equipped) and fasten the seat belt.



3. Drive the loader to the rear of the attachment. Put the loader quick attach coupler into the attachment mounting bracket.

4. Tilt the loader coupler backward a small amount until it is fully engaged in the attachment mounting bracket.



5. Stop the engine and engage the park brake.

6. Secure the coupler locking mechanism that attaches the attachment to the loader.

## USER'S MOUNTING INSTRUCTIONS

---

7. Connect the hydraulic quick couplers from the attachment to the loader.

**IMPORTANT:** Wipe the ends of the hydraulic quick couplers (both lead and loader) with a rag to remove any possible contamination. Contamination can cause hydraulic components to fail and is not covered under warranty.

**IMPORTANT:** Make sure the quick couplers are fully engaged. If the quick couplers do not fully engage, check to see that the couplers are the same size and brand. Do not force the quick couplers together.

**NOTE:** See the loader's operator's manual for auxiliary hydraulic specifications and connection instructions.

**NOTE:** Attachment is shipped with 8FJX (1/2" Female JIC Swivel) fittings on the ends of the lead hoses.

8. Make sure the hoses are properly routed to fit your specific loader. If the hoses are not routed correctly, hoses may get pinched or rub on tires. Be sure to check the hose routing through the full range of intended motion of the attachment before operating it.

More than one routing may be acceptable depending on the loader. Pick the routing that best suits your loader.

**IMPORTANT:** Proper hose routing is the responsibility of the owner and/or operator. Pinched or stretched hoses are not covered under warranty.

Mounting is now complete and you are ready to use the attachment. Use reverse order of above instructions to dismount the attachment from the loader.

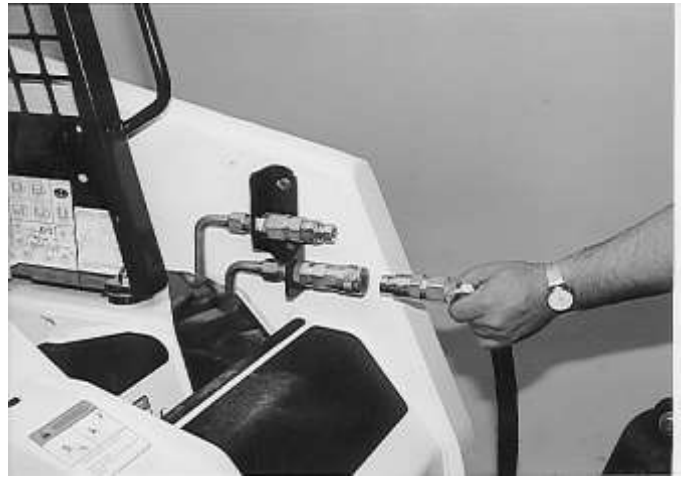



# OPERATING INSTRUCTIONS



**⚠ CAUTION** Always close the bucket securely before setting the attachment down on the ground. To avoid serious injury or death from crushing, **NEVER** put any body part near the bucket while open.

1. With the operator in the seat of the loader, the seat belt fastened, and the seat bar lowered (if so equipped), start the engine.
2. Activate the loader's auxiliary hydraulics to open and close the bucket.

## Standard Bucket Operation

Fully close the bucket against the dozer weldment in order to use the attachment as a standard bucket.

The opening bucket feature has two advantages during normal digging operations:

1. The operator may choose to open the bucket and scoop up small amounts of material by closing the bucket around it.
2. The combo bucket can dump at a greater height than a standard bucket by opening the bucket up when dumping into a truck or other container.



# OPERATING INSTRUCTIONS

## Bulldozing Operation

With the bucket fully open, tilt the dozer weldment forward until the dozer cutting edge engages the soil. Use the mounting plate tilt function on the loader to adjust the penetration depth. Move the loader forward to bulldoze.

**NOTE:** For steering lever functions, refer to the loader's operator's manual.

## Back-Drugging Operation

With the bucket fully open, tilt the dozer weldment so that the rear cutting edge of the bucket is on the ground and the dozer cutting edge is off of the ground. Angling the rear cutting edge on the ground enables the operator to remove sod or other substances off the ground.

**IMPORTANT:** Back-dragging material or pushing or scooping with the bucket **partially** open can result in damage to the attachment. Operating in this manner will void all warranties.

## Grapple Operation

1. Open the bucket enough to clear the object that is to be lifted.
2. Lower the attachment over the object so that the object is between the dozer cutting edge and the rear bucket cutting edge.
3. Close the bucket completely with enough force to clamp and hold the object to be lifted.
4. Use the loader's boom and tilt functions to lift, move, and place the object. Open the bucket to release the object once placed.

**⚠ WARNING** If the grappled object becomes unstable or unbalanced, lower the attachment to the ground and repeat the grappling process until the object being lifted remains stable the entire time it is being lifted and moved. Always lower the object to the ground before opening the bucket to release it.

**⚠ WARNING** To avoid injury or death, do not allow any person to be directly under the attachment or load at any time.

**⚠ CAUTION** Carry load as low as possible to avoid serious injury or death from tipping or falling load.







# ROUTINE MAINTENANCE

**⚠ WARNING** Lower the attachment to rest flat on the ground, shut down the engine, relieve the hydraulic pressure to the attachment, set the park brake, and wait for all motion to stop before leaving the operator's seat to perform service of any kind.

It is the operator's responsibility to make daily inspections of the loader and attachment for damage, loose bolts, fluid leaks, or anything else that could cause a potential service or safety problem. Preventive maintenance is the easiest and least expensive type of maintenance.

**IMPORTANT:** Bolts can loosen after initial usage. After the first hour of operation check all bolts.

## LUBRICATION

<b>Lubrication Legend</b>	 Multipurpose spray lube	 No. 2 Lithium base gun grease	 Clean engine oil	 <b>50</b> Intervals at which lubrication is required
---------------------------	---	---	--	--

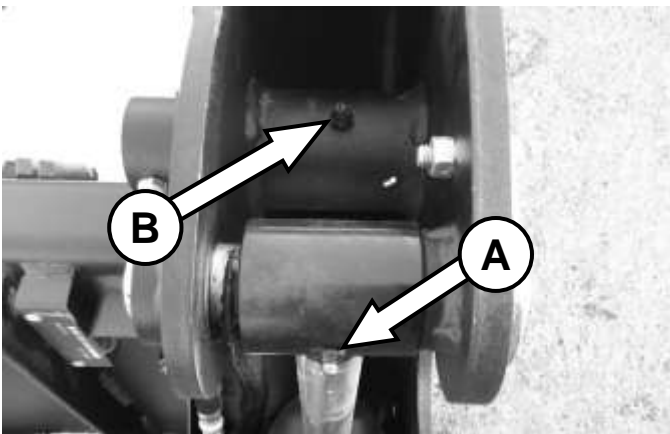

Use No. 2 lithium base gun grease when lubricating all attachment grease fittings.

		<b>8</b>
--	---	----------

Grease all four cylinder zerks **[A]** and both pivot bushing zerks **[B]** after every **8 hours** of operation.

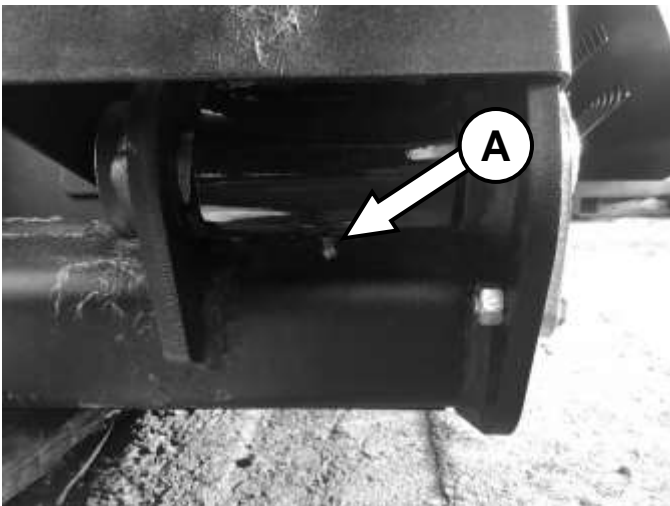

# BOLT TORQUE INFORMATION

## Torque-Tension Relationships for SAE J429 Grade Bolts

Nominal Thread Size	SAE J429 Grade 2			SAE J429 Grade 5			SAE J429 Grade 8		
	Clamp Load (lbs)	Tightening Torque		Clamp Load (lbs)	Tightening Torque		Clamp Load (lbs)	Tightening Torque	
		K = .15	K = .20		K = .15	K = .20		K = .15	K = .20
<b>Unified Coarse Thread Series</b>									
1/4-20	1,300	49 in-lbs	65 in-lbs	2,000	75 in-lbs	100 in-lbs	2,850	107 in-lbs	143 in-lbs
5/16-18	2,150	101	134	3,350	157	210	4,700	220	305
3/8-16	3,200	15 ft-lbs	20 ft-lbs	4,950	23 ft-lbs	31 ft-lbs	6,950	32.5 ft-lbs	44 ft-lbs
7/16-14	4,400	24	30	6,800	37	50	9,600	53	70
1/2-13	5,850	36.5	49	9,050	57	75	12,800	80	107
9/16-12	7,500	53	70	11,600	82	109	16,400	115	154
5/8-11	9,300	73	97	14,500	113	151	20,300	159	211
3/4-10	13,800	129	173	21,300	200	266	30,100	282	376
7/8-9	11,425	125	166	29,435	321	430	41,550	454	606
1-8	15,000	187.5	250	38,600	482.5	640	54,540	680	900
<b>Unified Fine Thread Series</b>									
1/4-28	1,500	55 in-lbs	75 in-lbs	2,300	85 in-lbs	115 in-lbs	3,250	120 in-lbs	163 in-lbs
5/16-24	2,400	112	150	3,700	173	230	5,200	245	325
3/8-24	3,600	17 ft-lbs	22.5 ft-lbs	5,600	26 ft-lbs	35 ft-lbs	7,900	37 ft-lbs	50 ft-lbs
7/16-20	4,900	27	36	7,550	42	55	10,700	59	78
1/2-20	6,600	41	55	10,200	64	85	14,400	90	120
9/16-18	8,400	59	79	13,000	92	122	18,300	129	172
5/8-18	10,600	83	110	16,300	128	170	23,000	180	240
3/4-16	15,400	144	193	23,800	223	298	33,600	315	420
7/8-14	12,610	138	184	32,480	355	473	45,855	500	668
1-12	16,410	205	273	42,270	528	704	59,670	745	995

Clamp load estimated as 75% of proof load for specified bolts.

Torque values for 1/4 and 5/16 inch series are in inch-pounds. All other torque values are in foot-pounds.

Torque values calculated from formula  $T = KDF$

where:  $K=0.15$  for "lubricated" conditions

$K=0.20$  for "dry" conditions

## PARTS INFORMATION

ITEM	QTY	PART NO.	DESCRIPTION	STOCK NO.
1	2	13107	BOLT HEX	3/8 X 1-1/4 NC GR 5
2	2	300104	PIN 1.25 X 5.125 W/A	
3	2	33008	WASHER FLAT 3/8	<b>OLD STYLE ONLY</b>
4	6	37212	NUT LOCK	3/8 NC
5	2	318060	PIN 1.50 X 7.5 W/HOLE	
6	2	13113	BOLT HEX	3/8 X 2-1/2 NC GR 5
7	2	318099	SHIELD CYLINDER WIDE PAINTED	
	2	318063	SHIELD CYLINDER PAINTED	<b>OLD STYLE ONLY</b>
8	4	103880	WASHER	LOCK 3/8
9	1	300995	COMBO BUCKET 66 W/A	<b>REPLACED 318005</b>
	1	300997	COMBO BUCKET 72 W/A	<b>REPLACED 318006</b>
	1	300999	COMBO BUCKET 80 W/A	<b>REPLACED 318007</b>
	1	318005	COMBO BUCKET 66 W/A	<b>OLD STYLE</b>
	1	318006	COMBO BUCKET 72 W/A	<b>OLD STYLE</b>
	1	318007	COMBO BUCKET 80 W/A	<b>OLD STYLE</b>
10	6	13105	BOLT HEX	3/8 X 1 NC GR 5
11	1	300994	COMBO FRAME 66 W/A	<b>REPLACED 318001</b>
	1	300996	COMBO FRAME 72 W/A	<b>REPLACED 318002</b>
	1	300998	COMBO FRAME 80 W/A	<b>REPLACED 318003</b>
	1	318001	COMBO FRAME 66 W/A	<b>OLD STYLE</b>
	1	318002	COMBO FRAME 72 W/A	<b>OLD STYLE</b>
	1	318003	COMBO FRAME 80 W/A	<b>OLD STYLE</b>
19	4	32467	BOLT THDCUT FLG	3/8 X 3/4 NC
	1	318090	MOUNT FRAME SPACER W/A	SPECIAL ORDER
20	2	312104	PIN 1.25 X 6 W/A	<b>NEW STYLE</b>

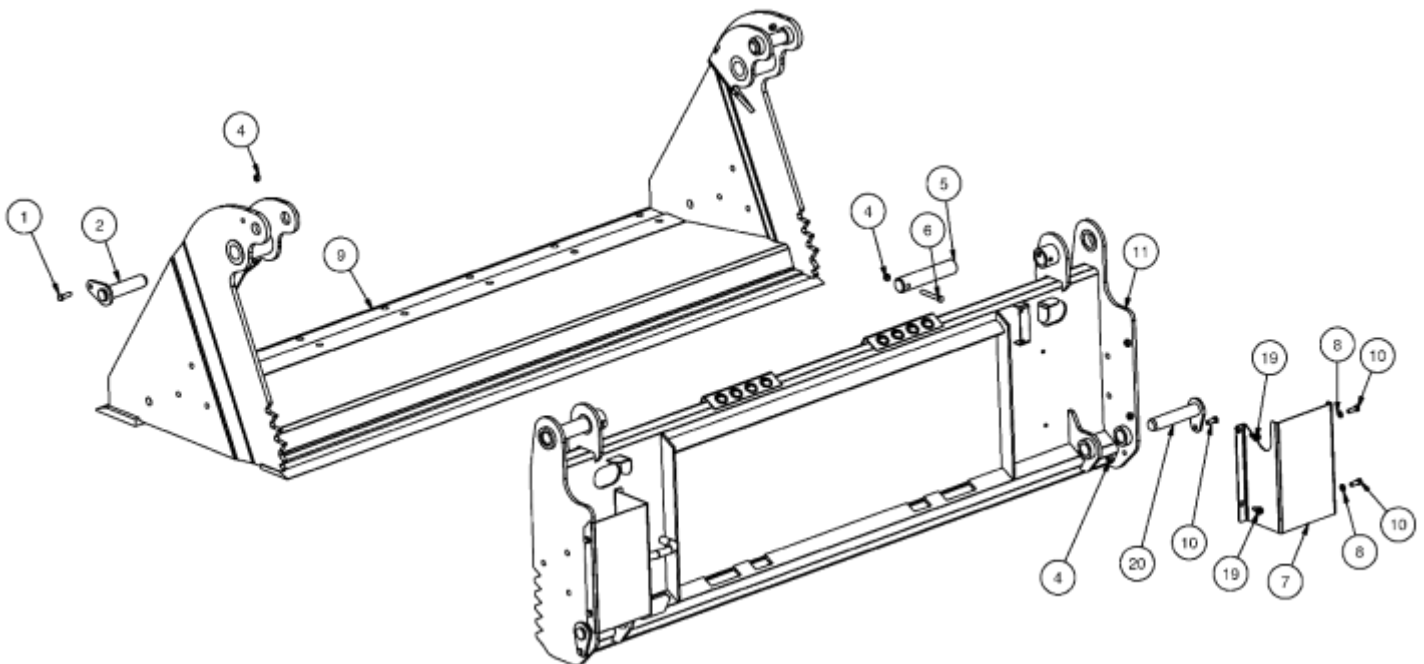

## PARTS INFORMATION

ITEM	QTY	PART NO.	DESCRIPTION	STOCK NO.
1	1	318081	HOSE 1/4 X 77 6FJX-6FJX-45	CYL ROD END
	1	318083	HOSE 1/4 X 69 6FJX-6FJX-45	CYL ROD END
	1	318085	HOSE 1/4 X 63 6FJX-6FJX-45	CYL ROD END
2	1	318082	HOSE 1/4 X 95 6FJX-6FJX	CYL BASE END
	1	318084	HOSE 1/4 X 87 6FJX-6FJX	CYL BASE END
	1	318086	HOSE 1/4 X 81 6FJX-6FJX	CYL BASE END
3	2	320089	ADPT ELB 8MB-6MJ-90	RH CYL
4	1	318087	HOSE 3/8 X 67 6FJX-8FJX	LEAD (72" & 88" ONLY)
	1	318091	HOSE 3/8 X 67 6FJX-90-8FJX	LEAD (66" ONLY)
5	1	320145	ADPT TEE 6MJ-6MJ-8MB	LH CYL ROD
6	2	300979	CYLINDER 3 X 6 16.25 B-B	<b>NEW REPLACED 317063</b>
	2	317063	CYLINDER 3 X 6 16.25 C-B	<b>OLD STYLE ONLY</b>
7	1	318080	ADPT TEE 6MJ-8MB-6MJ	LH CYL BASE
8	1	318067	HOSE 3/8 X 77 6FJX-8FJX	LEAD
9	4	65127	PIN COTTER 3/16 X 2	<b>USE WITH 317063 CYL ONLY</b>
10	2	320127	PIN CYLINDER	<b>USE WITH 317063 CYL ONLY</b>

# PARTS INFORMATION

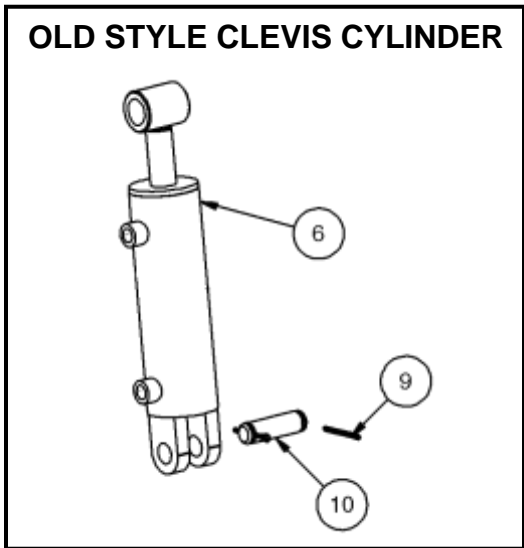
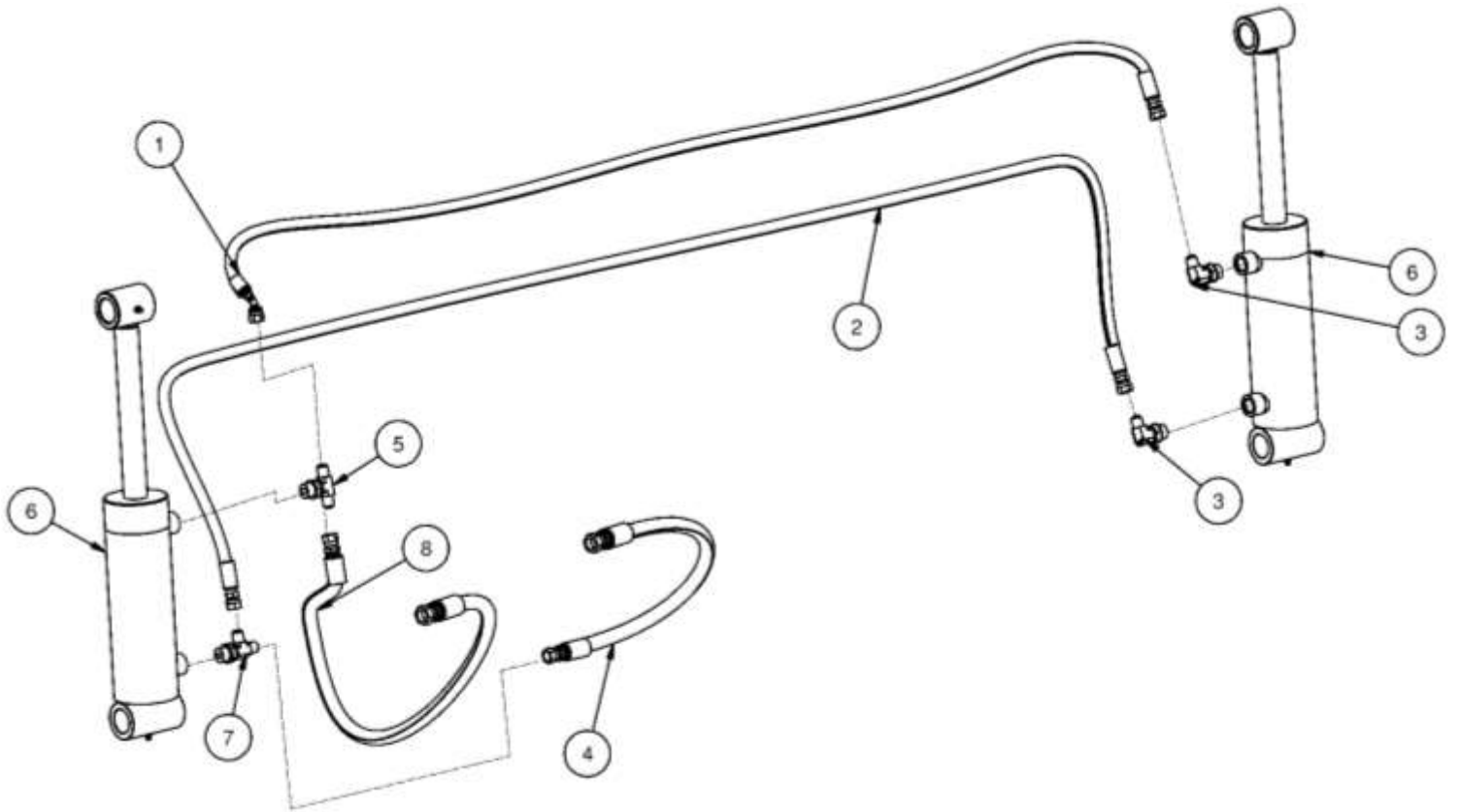

## OPTIONAL PARTS INFORMATION

ITEM	QTY	PART NO.	DESCRIPTION	STOCK NO.
3	1	312262	CUTTING EDGE B 68 DB	
	1	318430	CUTTING EDGE B 74 DB	
	1	318093	CUTTING EDGE B 82 DB	
4	6(66") 7(72") 8(80")	22665	BOLT PLOW	5/8 X 2 NC GR5
5	6(66") 7(72") 8(80")	300745	TOOTH BOLT ON	
		312280	TOOTH BOLT ON	<b>OBSOLETE – PARTS ONLY</b>
6	6(66") 7(72") 8(80")	300746	PIN ROLL	
		312281	PIN ROLL	<b>OBSOLETE – PARTS ONLY</b>
7	12(66") 14(72") 16(80")	33630	WASHER LOCK 5/8	<b>BOLT ON TEETH OPTION</b>
	6(66") 7(72") 8(80")			<b>DB CUTTING EDGE OPT</b>
8	12(66") 14(72") 16(80")	36314	NUT HEX FULL	5/8 NC GR5
9	6(66") 7(72") 8(80")	300744	TOOTH ADAPTER BOLT ON	
		312277	TOOTH ADAPTER BOLT ON	<b>OBSOLETE</b>
10	12(66") 14(72") 16(80")	94407	BOLT FH SCKT CAP	5/8 X 2-1/2 NC GR 5
11	1	312250	TOOTHBAR 66 W/A	
	1	312251	TOOTHBAR 72 W/A	
	1	312252	TOOTHBAR 80 W/A	
12	2	37217	NUT REV LOCK	3/4 NC
13	4	33018	WASHER FLAT	USS 3/4
14	2	13361	BOLT HEX	3/4 X 2 NC GR 5



# OPTIONAL PARTS INFORMATION

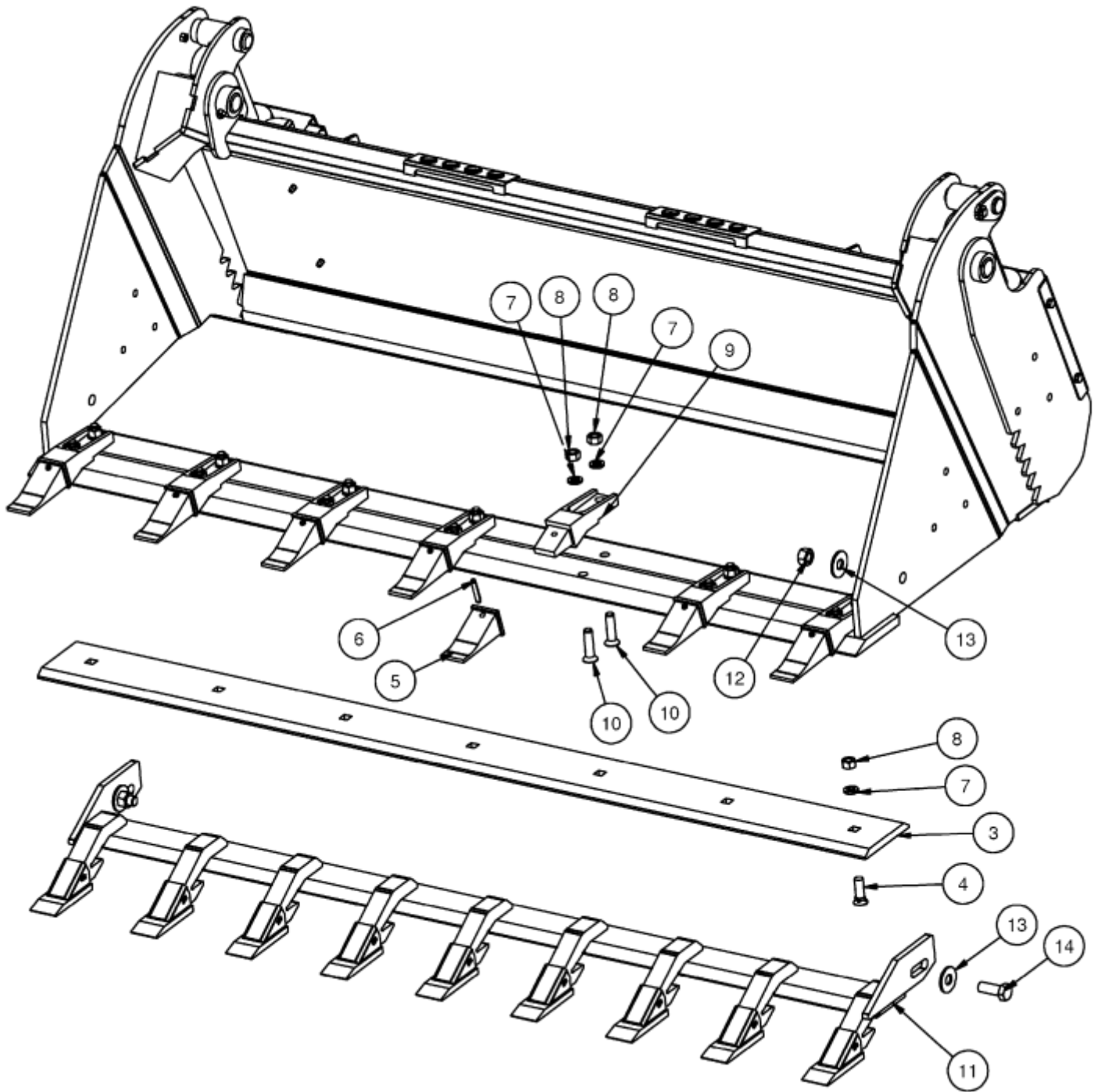

## GENERAL SPECIFICATIONS

Model	66	72	80
Working Width	66"	72"	80"
Overall Width	68"	74"	82"
Height	28"		
Length	34"		
Open Bucket Angle	75°		
Cutting Edge – Front	3/4" x 6" weld-on		
Cutting Edge – Rear	1/2" x 4" weld-on		
Cylinders (2)	3" x 8", 3000 psi		
Operating Weight	800 lbs.	840 lbs.	900 lbs.

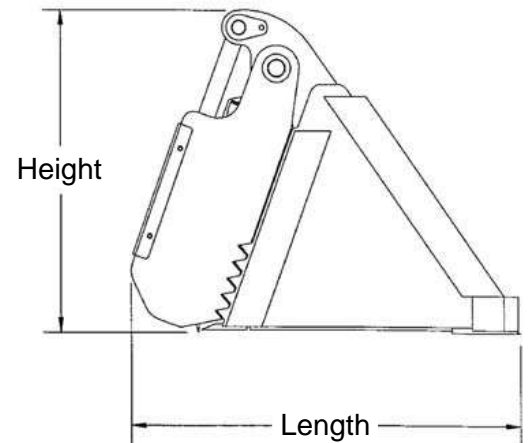
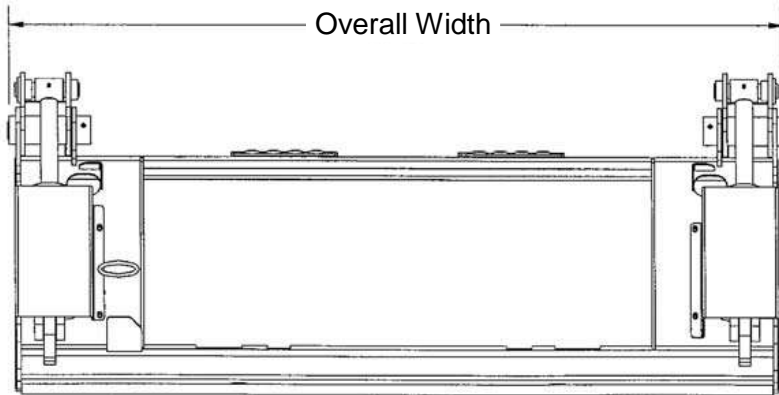

All dimensions are in INCHES.

## LIMITED WARRANTY

Erskine Attachments LLC warrants each new machine manufactured by us to be free from defects in material and workmanship for a period of twelve (12) months from date of delivery to the original purchaser.

Our obligation under this warranty is to replace free of charge, at our factory or authorized dealership, any part proven defective within the stated warranty time limit.

All parts must be returned freight prepaid and adequately packaged to prevent damage in transit.

This warranty does not cover:

1. New products which have been operated in excess of rated capacities or negligence
2. Misuse, abuse, accidents or damage due to improperly routed hoses
3. Machines which have been altered, modified or repaired in any manner not authorized by our company
4. Previously owned equipment
5. Any ground engaging tools in which natural wear is involved, i.e. tooth tips, cutting teeth, etc
6. Normal maintenance
7. Fork tines
8. Hydraulic motors that have been disassembled in any manor

In no event will the Sales Representative, Dealership, Erskine Attachments LLC, or any other company affiliated with it or them be liable for incidental or consequential damages or injuries, including but not limited to the loss of profit, rental or substitute equipment or other commercial loss. Purchaser's sole and exclusive remedy being as provided here in above.

Erskine Attachments LLC must receive immediate notification of defect and no allowance will be made for repairs without our consent or approval.

This warranty is in lieu of all other warranties, express or implied by law or otherwise, and there is no warranty of merchantability or fitness purpose.

No agent, employee, or representative of Erskine Attachments LLC has any authority to bind Erskine Attachments LLC to any warranty except as specifically set forth herein. Any of these limitations excluded by local law shall be deemed deleted from this warranty; all other terms apply.

This warranty may not be enlarged or modified in any manner except in writing signed by an executive officer of Erskine Attachments LLC to improve its products whenever it is possible and practical to do so. Erskine Attachments LLC reserves the right to make changes and or add improvements at any time without incurring any obligation to make such changes or add such improvements to products previously sold.

Erskine Attachments LLC  
P.O. Box 1083 Alexandria, MN 56308  
Phone (218) 435-4045 Fax (218) 435-5293



**P/N 320194**  
Erskine Attachments LLC

**Date Printed: 2/4/2019**

Printed in U.S.A.